

GAUGE WHEEL SCRAPER MOUNTING INSTRUCTIONS

Great Plains Precision Planters

(Read Instructions Completely before Beginning Installation)

Before working on your planter or drill

DANGER: when storing or working on the planter always install cylinder stops or place the planter on stands to prevent personal injury or damage to the attachments.

Mounting Instructions

Before you begin, verify the “package contents” to ensure all items are included.

Step #1: remove the gauge arm pinch bolt. Assemble tee bar and scraper as shown paying attention that the tee bar bolt (1/2 x 1”) is in the center hole on angle iron. (The hole closer to the edge or off centered hole is for the 1/2 x 3” gauge arm pinch hole). Position assembly as per picture and tighten all bolts.

Step #2: be sure to spin tire to set clearance. Also, check for any interference from adjoining rows.

Great Plains Gauge Wheel Scraper Package Contents (per single side)	
Item	Quantity
1/2" x 3" Bolt	1
1/2" Lock Washers	2
1/2" x 1" Bolt	1
1/2" Nuts	2
1/4" x 1" Carriage Bolt	2
1/4" Whiz Nuts	2
Large (JD style) OR Small (square) Scraper	1
Scraper Bracket	1
Angled Bracket	1
Instruction Sheet	1

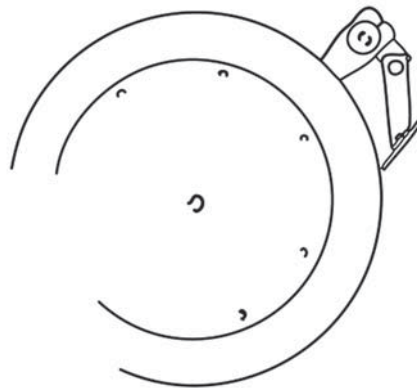
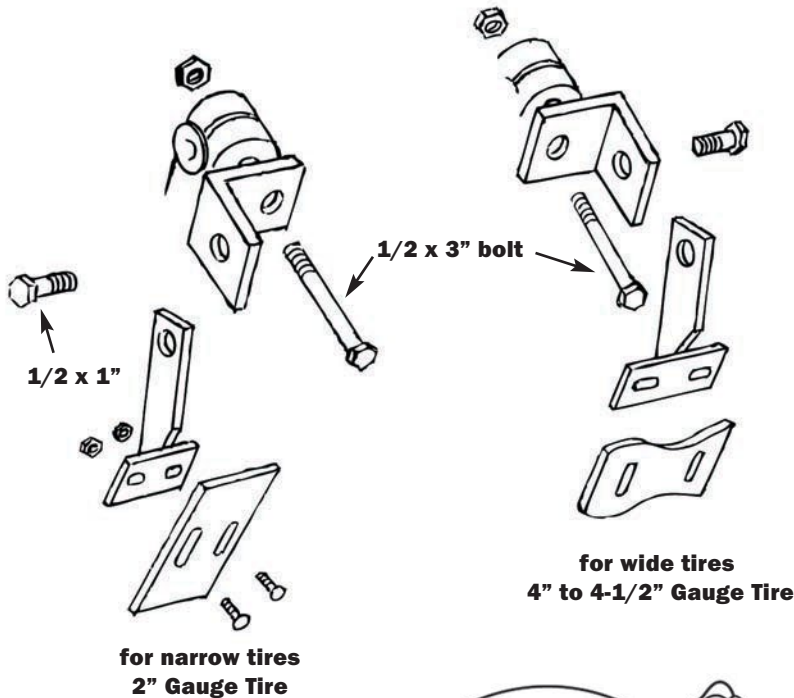

typical wheel