

REBOUNDER™ MOUNTING INSTRUCTIONS

Tye Drills

(Read Instructions Completely before Beginning Installation)

Before working on your planter or drill

DANGER: When storing or working on the drill always install cylinder stops or place the drill on stands to prevent personal injury or damage to the Rebounder. **WARNING:** Do not roll back or back up the drill in or on the ground as this can result in damage to the Rebounder.

Mounting Instructions

Before you begin, verify all items listed in the "package contents" table at the right.

NOTE: ■ See HELPFUL HINTS FOR MOUNTING REBOUNDERS TO DRILLS (on back).

Step #1: **NOTE:** If applying liquids in furrow with the Rebounder, attach either Y-Not Split It, Hose Holder, or Straight Shot kit by following kit directions. See kit instructions.
INSTALL KIT BEFORE INSTALLING REBOUNDER TO BRACKET [fig. (b)] IF USING LIQUIDS IN-FURROW.

Step #2: Place the Rebounder on top of the mounting bracket. The bracket's top hole should line up to the Rebounder's top hole, and the bracket's third from top hole will line up with the Rebounder's bottom hole. Insert the 1/4 x 1" bolts through these holes, going first through the Rebounder, then through the bracket. Thread the whiz nuts over the bolts on the backside of the bracket [fig. (a)]. Tighten.

NOTE: If applying liquids in furrow, place the fertilizer kit's L-bracket and washer under the bottom bolt [fig. (b)].

Step #3: Remove the Tye Drill scraper nut and install the Rebounder bracket over the scraper. Re-install the nut and tighten it into place [fig. (c)]. The Rebounder will naturally hang below disc blades 1"-2", and flex up when planting to follow the seed V made.

Contact Schaffert Mfg. 800-382-2607 for Tye Drill parts

Rebounder Package Contents (per single row)	
Item	Quantity
Rebounder	1
1/4 x 1" Bolt	2
Whiz Nut	2
Instruction Sheet	1
Bracket Package Contents (per single row)	
Item	Quantity
Mounting Bracket	1

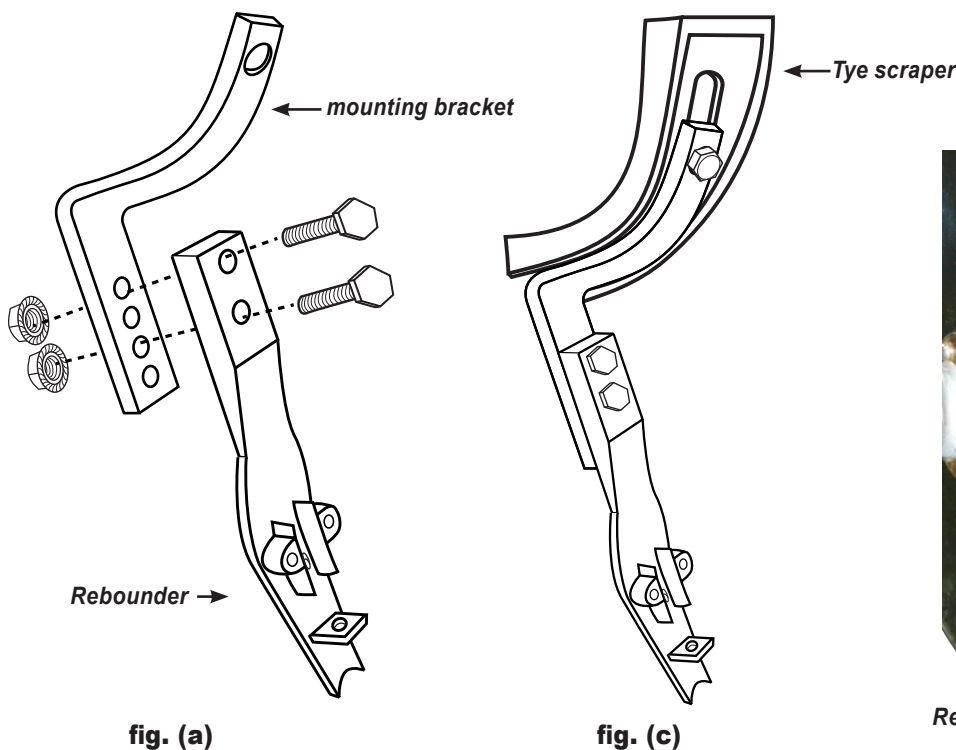
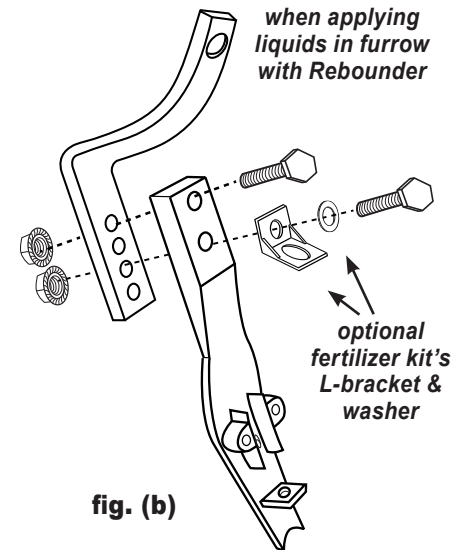

Rebounder covered by one or more of the following U.S. patents: 5,640,915; 5,918,557; 6,082,275; 6,283,050; 6,453,832; 6,763,773 and 7,121,216.

HELPFUL HINTS FOR MOUNTING THE REBOUNDER™ ON DRILLS

(Read Instructions Completely before Beginning Installation)

Before working on your planter or drill

DANGER: When storing or working on the drill always install cylinder stops or place the drill on stands to prevent personal injury or damage to the Rebounder.

WARNING: Do not roll back or back up the drill in or on the ground as this can result in damage to the Rebounder.

Helpful Hints

Step #1: use a farm jack on the press wheel to raise up the drill unit 3-4" before you mount the first row.

IMPORTANT: have press wheel adjusting handle of knob, in the position you would normally run in the field (see **fig (a)**).

Step #2: slide a board or piece of flat iron under the double disc openers and back under the press wheel tire. The board or flat iron represents the bottom of the seed V.

Step #3: now you can bolt the Rebounder to the bracket on the drill. Position the Rebounder on the bracket so that the trailing end will be from 3/8" - 1/2" off the board or flat iron. Using the 1/4" bolts attach the Rebounder to the bracket on the drill.

Step #4: variances in the disc blade size will occur among individual drills as well as within any single drill. Measure discs behind the tire track rows. If they are worn more than other rows this process may need to be used to set these rows also.

Step #5: if replacing Rebounders on previously installed brackets, simply remove the old Rebounder without removing the disc blade. Using a small bar magnet or a long handled magnet, place the bolt on the magnet and slide it up between the discs and into the holes of the bracket and the Rebounder. This allows you to come in behind with a wrench or socket to install and tighten the nuts.

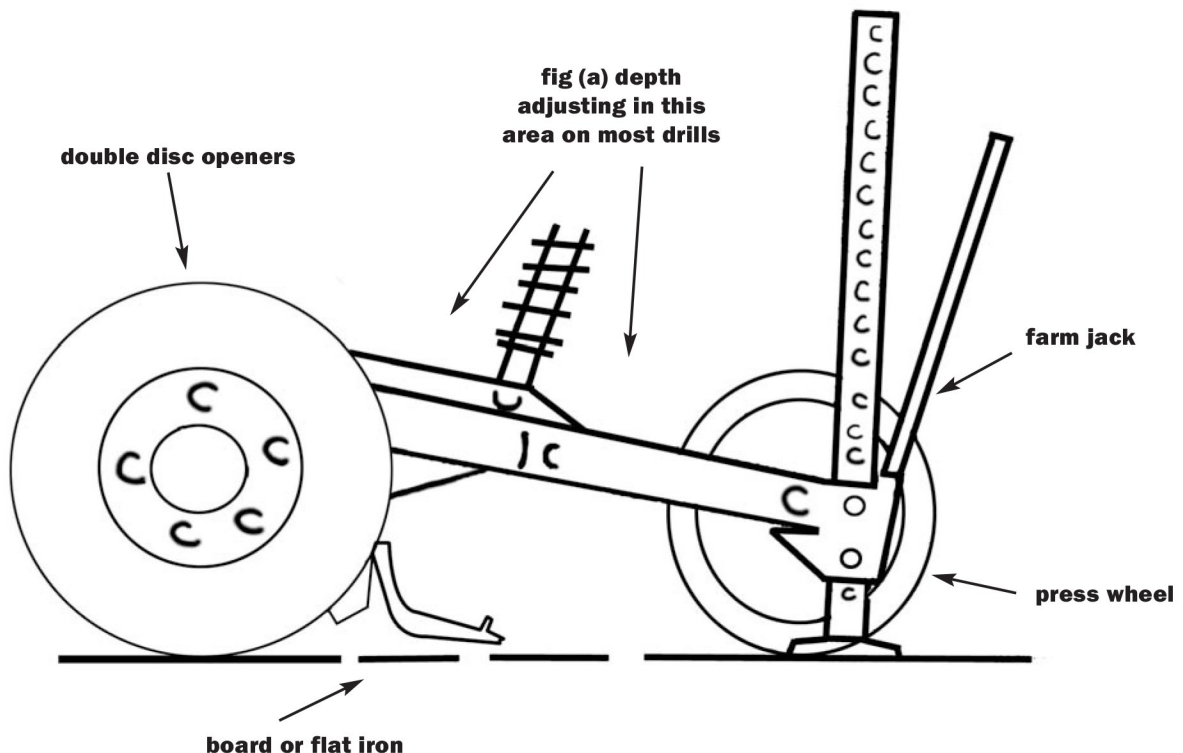

Rebounder covered by one or more of the following U.S. patents: 5,640,915; 5,918,557; 6,082,275; 6,283,050; 6,453,832; 6,763,773 and 7,121,216.

71495 rd. 397 - indianola, ne 69034 - phone: 800-382-2607 - fax: 308-364-2410 - sales@schaffert.com - www.schaffert.com - Sept 18, 2009