

REBOUNDER™ MOUNTING INSTRUCTIONS

John Deere Drills 455,515,1520, & 8300

(Read Instructions Completely before Beginning Installation)

Before working on your planter or drill

DANGER: when storing or working on the planter always install cylinder stops or place the planter on stands to prevent personal injury or damage to the Rebounder. **WARNING:** do not roll back or back up the planter in or on the ground as this can result in damage to the Rebounder.

Mounting Instructions

Before you begin locate the “package contents” list to verify all items are included.

Step #1: See HELPFUL HINTS FOR MOUNTING REBOUNDERS TO DRILLS.

Remove one disc from each drill unit so the Rebounder and bracket can be installed properly.

Step #2: remove the angel wing disc scrapers and hardware from each unit (**fig. (a)**). The scrapers will not be used as the Rebounder and bracket take the place of the scrapers (the Rebounder bracket also acts as a scraper).

Step #3: use one of the 1/4" x 1" bolts and lock nut provided to mount the Rebounder bracket into the place where the scraper had been (**fig. (b)**).

Step #4: see **JD Drill Bracket template sheet** to match your drill.

Step #5: you are now ready to bolt the Rebounder to the bracket on the drill. For Example: with new discs on the drill and the press wheel adjusting handle in the 3rd and 4th notches down from the top, a good starting point would be putting the 1/4" bolts in the 1st and 3rd holes from the top of the bracket. Place the Rebounder on the bottom side of the bracket in the 1st and 2nd holes closest to the spoon. Mount the Rebounder (**fig. (c)**) to the bracket (**fig. (d)**) along with the L-bracket, using two 1/4" x 1" bolts.

Step #6: Position the Rebounder so that the tail end will be from 3/8" or 3/8" to 1/2" off the ground or floor. Re-install the discs.

Rebounder Package Contents (per single row)	
Item	Quantity
Rebounder	1
L-bracket	1
1/4 x 1" bolts	2
1/4" whiz nut	1
1/4" nut	1
Instruction Sheet	1
Bracket Template Sheet	1

Bracket Package Contents (per single row)	
Item	Quantity
Bracket	1
1/4x1" bolt	1
lock nut	1

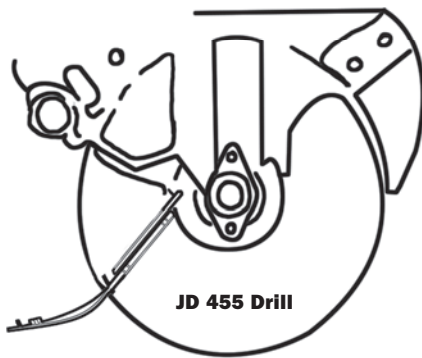

JD Drills 455, 515, 1520 & 8300
w/ single or double closing wheels

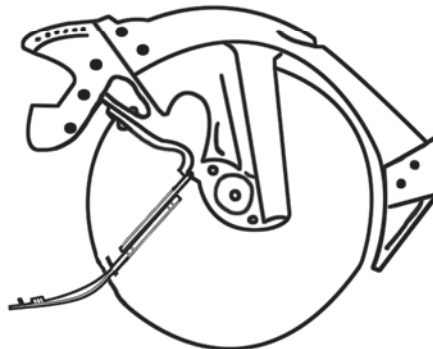

JD Drills 455, 515, 1520 & 8300 w/
depth gauge wheels mounted along side
the double disc openers

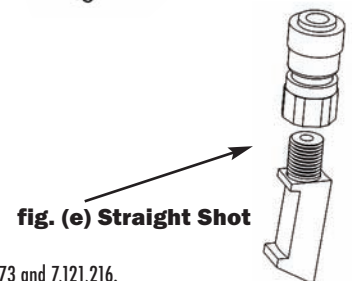
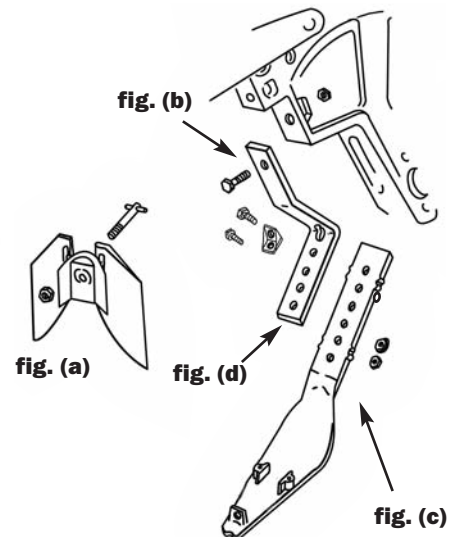

fig. (e) Straight Shot

Important Points to Remember:

- If the fertilizer holder is used, the flange nut will be used on that bolt and other 1/4" plain nut on the second bolt. Replace the disc when finished. The molded in tab is for in-furrow applications.
- Optional Straight Shot Fittings are also available upon request for a small charge. The Straight Shot fitting (see fig. (e)) is used for keeping fertilizer from building up on the press wheel. This puts fertilizer directly on the seed and should be used when you notice excessive soil and fertilizer build up on the press wheel tire.

Rebounder covered by one or more of the following U.S. patents: 5,640,915; 5,918,557; 6,082,275; 6,283,050; 6,453,832; 6,763,773 and 7,121,216.

JOHN DEERE DRILL BRACKET TEMPLATE SHEET

**JD Drills Including Some Series 455, 515, 520, 1520, & 8300
with or without Gauge Wheels**

Before working on your planter or drill

DANGER: when storing or working on the planter always install cylinder stops or place the planter on stands to prevent personal injury or damage to the Rebounder. **WARNING:** do not roll back or back up the planter in or on the ground as this can result in damage to the Rebounder.

Brackets

Note that these drawings are actual size of your JD brackets. The 4 black areas represent the holes in each bracket. Use these templates to shape your brackets. After the brackets are bent to fit your drill - fit and trim the Rebounder to fit. Cut off excess holes with side cutters.



ORIGINAL BRACKET #1 (SENT FROM FACTORY)

This bracket may be reshaped to fit your specific drill by putting it into a vice and bending at a curve. Reshape only the side that has four holes. It fits some JD 455, 515, 520, 1520, & 8300 drills without the Gauge Wheels.

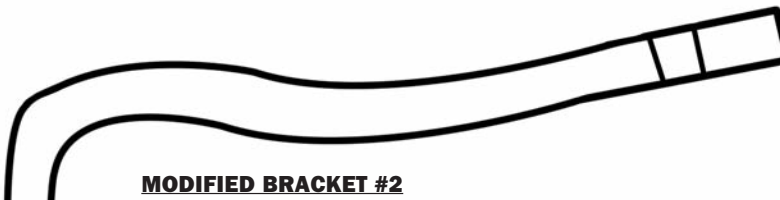

MODIFIED BRACKET #2

This bracket fits some JD 450 and possibly other 515, 520, and 8300 without Gauge Wheels.



MODIFIED BRACKET #3

This bracket fits some JD Drills with Gauge Wheel brackets. Examples include: 450, 515, 520, and 8300.