

IH STYLE FERTILIZER DISC "OUT THE BACK" MOUNTING INSTRUCTIONS

IH Style 800 / 900 / 950 / 955 / 1200 Series Planter

(Read Instructions Completely before Beginning Installation)

Before working on your planter or drill

DANGER: When storing or working on the planter always install cylinder stops or place the planter on stands to prevent personal injury or damage to the attachments.

Mounting Instructions

Before you begin, verify all items listed in the "package contents" table at the right.

Step #1: Remove leading concave covering disc from planter and replace with straight fertilizer disc. Bearing side of disc should face out or away from disc mounting arm. This will place fertilizer 3" to the side from the center of the seed furrow. This provides additional spacing between the fertilizer disc and packer wheel.

Step #2: Using 5/8 x 3" bolt, place fertilizer arm and scraper over bolt.

Step #3: Put bearing, disc and hub assembly (BDH) on 5/8 x 3" bolt with bearing toward the fertilizer arm.

Step #4: Next add the three 5/8" lock washers to the inside of the disc to space the liquid disc out so it is 3" away from the center of the furrow like the original covering disc was.

FYI: By adding the washers one moves the disc out into firm soil away from the softer mounded soil next to the seed V left by Case IH gauge wheel tire. This helps keep the disc from plugging as well as fertilizer off the press tire.

Step #5: Place 5/8" nut on inside of cover disc arm.

Step #6: Tighten bolt into place. Be sure fertilizer arm runs parallel to the soil surface. There are right and left arm brackets.

IH 1200 Fertilizer Disc Package Contents (per single row)	
Item	Quantity
8" Blade	1
Hub	1
Bearing	1
1/4 x 5/8" Bolt	6
1/4" Nut	6
Bracket (left or right)	1
5/8 x 3" Bolt	1
5/8" Nut	1
1" SS coupler	1
3/8 x 1" SS Bolt	1
3/8" SS Hose Barb	2
3/8" SS Whiz Locking Nut	2
5/8" Lock Washer	3
3/8 x 6" Hose	1
1/4" Close Nipple	1
1/4" 45° SS Elbow	1
Hose Clamp	1
Instruction Sheet	1

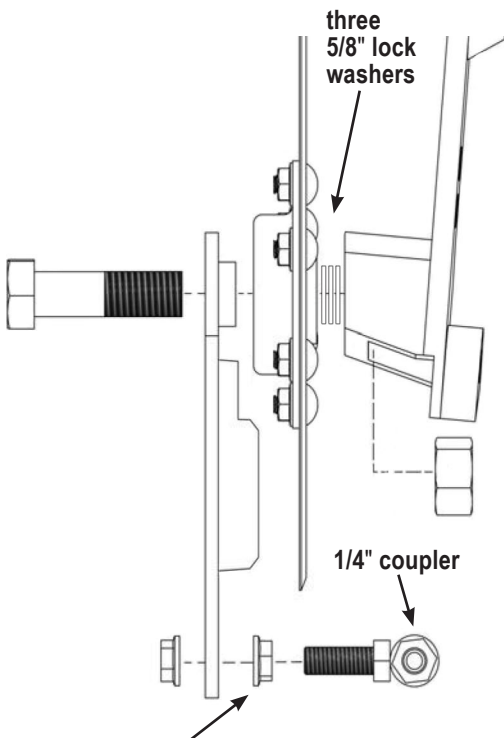

This whiz nut may be removed if you would like to move the liquid placement further away from the furrow.

Installing Hoses & Fittings to Fertilizer Arm

Step #1: Install one or both stainless steel hose bars into nipple that bolt is welded to. If you want the hose to drag back to not catch trash, then use 1/4" 45° elbow to angle hose back on planter.

Step #2: Two whiz nuts go on bolt and through arm that holds hoses for adjusting hose to outside of blade so fertilizer is placed in the slice made by the disc.

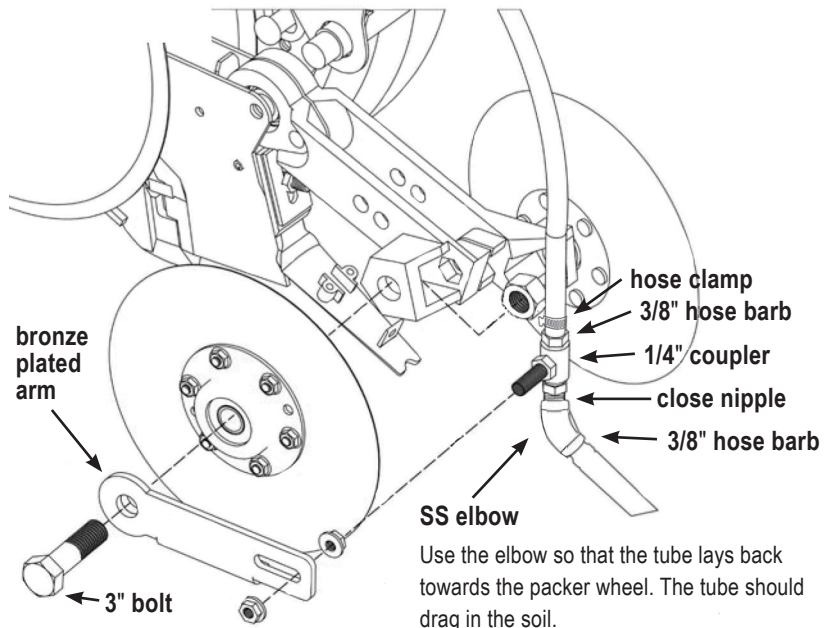

Use the elbow so that the tube lays back towards the packer wheel. The tube should drag in the soil.